

Motor size	1.7" flange – 42 mm square	Step Angle	1.8° ±5%
Gearbox Front Shaft	20.0 mm length – Ø 8.00 mm with D-cut 1.0 x 15.0 mm	Rear Shaft	None
Winding	# 4 lead wires – AWG26 UL1007 with connector on board	Lead Wire Length	1830 mm ±30
Rated Voltage	3.00 Volt	Rated Current	1.50 A/ph
Resistance	1.50 ohm ±10%	Inductance	2.40 mH ±20%
Winding	Bipolar parallel	Holding Torque	0.25 Nm min.
Rotor Inertia	40 g.cm²	Insulation resistance	100 Mohm (500Vdc)
Dielectric strength	500V AC 1 minute	Insulation class	Class B, 130°
Ambient temperature	-20° ~ +40° C	Temperature rise	80K max.
Gearbox type	Planetary	Gearbox ratio	1:5.18

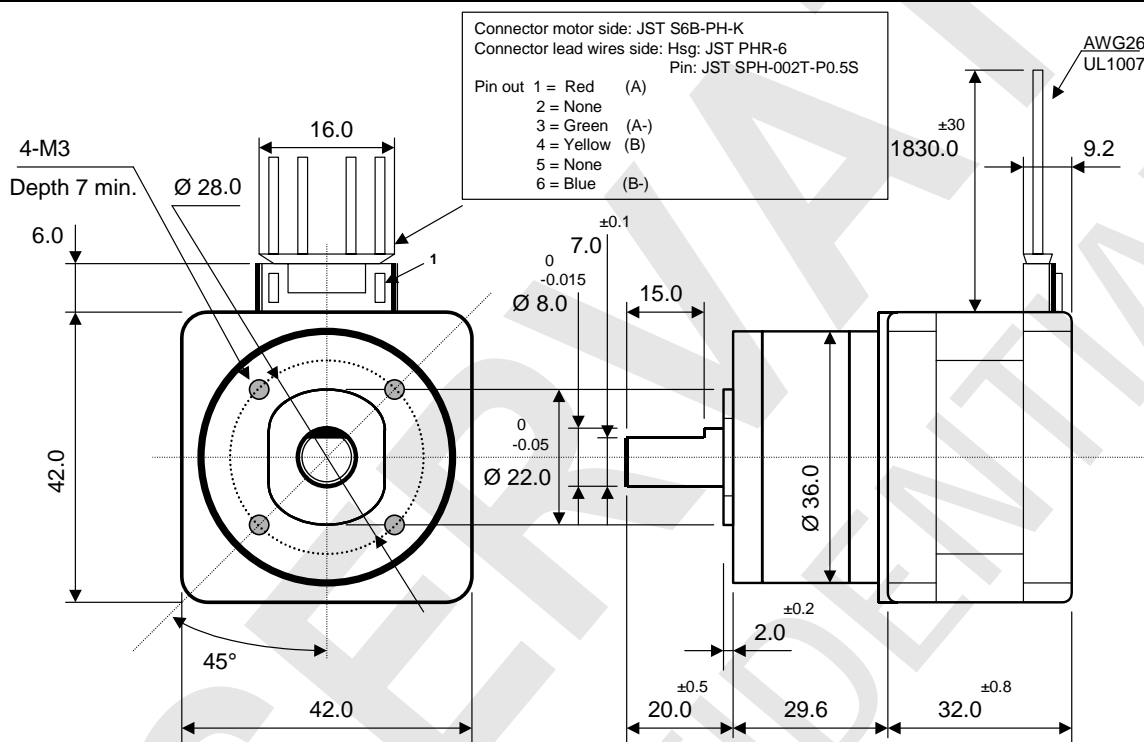

Wiring diagram

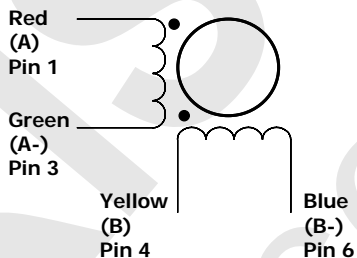

Rear flange

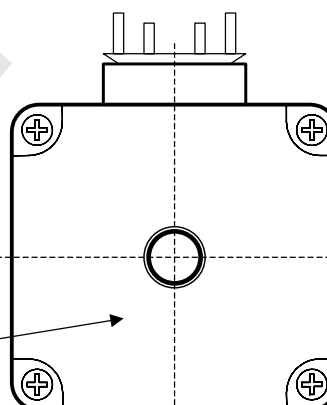

Motor Labelling

Label type: adhesive label

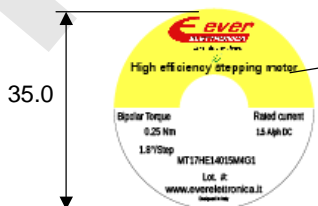

	Motor specification: STM01144-00f	Date: September, 13th 2016	Customer approval: _____
	Motor code: MT17HE14015M4G1		Customer p/n: _____